

Harcourts Kingsberry



12 Whitewood Close MOUNT LOUISA QLD

3 2 2

How can you be the envy of your friends?

This is a property that is going to make your family & friends jealous that they didn't see it first, that you did and acted. There are a multitude of reasons why this is going to be first on your list to visit this week end at the Open Homes.

- The locale alone is private, picturesque and central to amenities.
- The exposition of the property is without doubt perfect.
- Attention to detail throughout this home will attract your consideration.
- 800m2 block allows liberal room to house playful children & pets in the private, secure backyard.
- The fully powered 2 bay shed to the rear - easily accessible by the double gates will appeal to every man.

Price : \$ 389,000
Building Size : 25 Sqrs
Land Size : 800 sqm
View : <https://www.kingsberry.com.au/sale/qld/townsville-district/mount-louisa/residential/house/4326531>



Ben Kingsberry
07 4772 2022
0438 792 652

ben.kingsberry@tsvharcourts.com.au

<https://www.kingsberry.com.au>

210 Charters Towers Road Hermit Park QLD
07 47 722 022

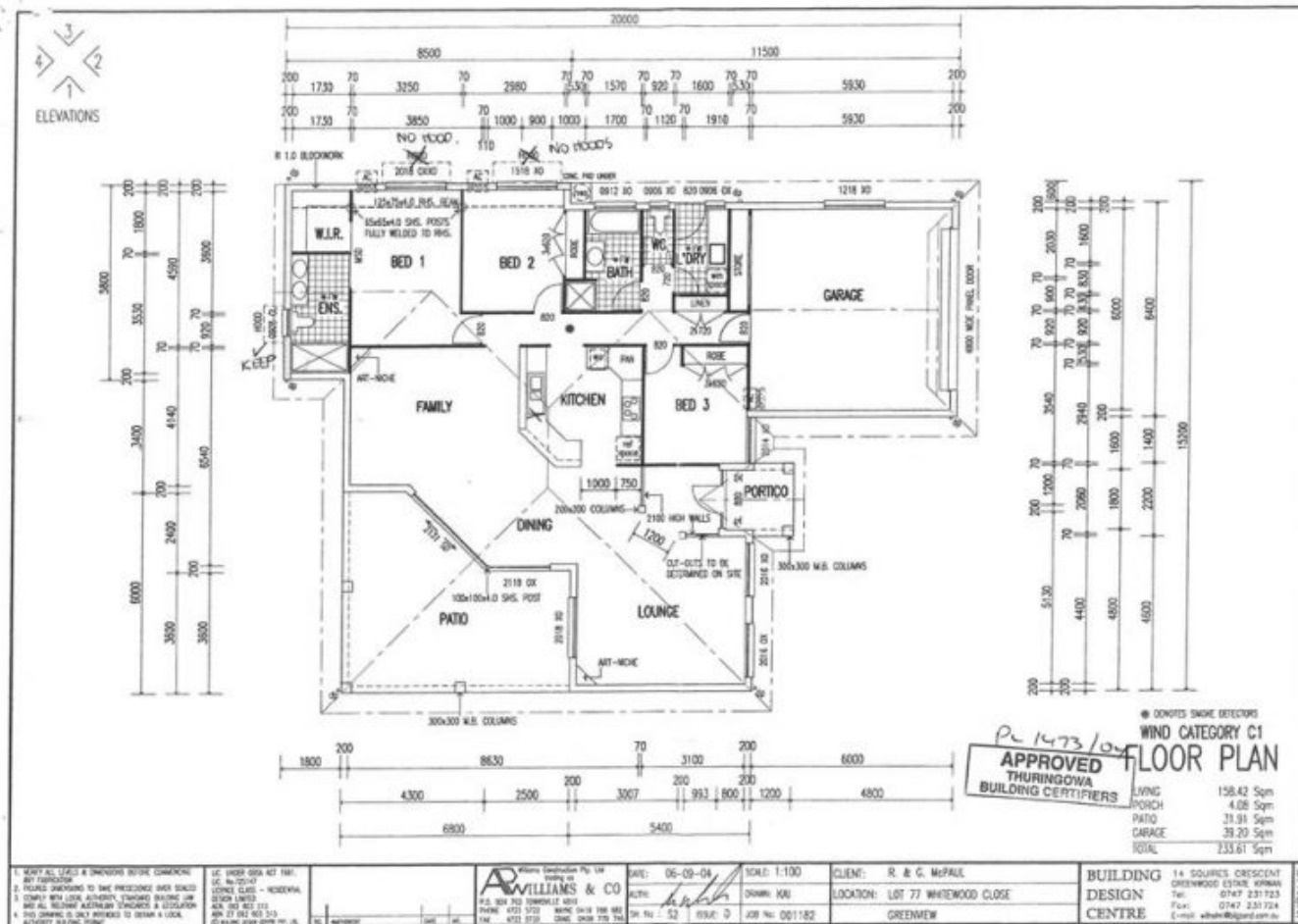

**BUILDING
DESIGN
CENTRE**