

# Harcourts Kingsberry



## 21 Solana Circuit BURDELL QLD

4 2 2

As soon as you step through the stylish front door into the heart of this lovely home one feels the shroud of calm. This lovely home has it all. With side access and a fantastic layout that allows airflow for the afternoon breezes you will always be cool. The open plan lounge/dining/kitchen with butler's pantry which can be closed off from the rest of the house allows for plenty of quality family time. You also have a media room at the front of the house when you need some peace and quiet. Outside you can relax on the back patio with plenty of room in the back yard for the kids and with only one neighbour you don't feel boxed in. With parks in walking distance as well as dog park, pool, gym and schools it's all within minutes of home. This is the perfect home in the perfect area. You must see this home before you miss out!

**Price** : \$ 385,000  
**Land Size** : 706 sqm  
**View** : <https://www.kingsberry.com.au/sale/qld/townsville-district/burdell/residential/house/4326542>



John Mendo  
07 4772 2022  
0438 792 888  
[john.mendo@tsvharcourts.com.au](mailto:john.mendo@tsvharcourts.com.au)

Window Schedule	Work History With Description
1990-1991	...
1992-1993	...
1994-1995	...
1996-1997	...
1998-1999	...
2000-2001	...
2002-2003	...
2004-2005	...
2006-2007	...
2008-2009	...
2010-2011	...
2012-2013	...
2014-2015	...
2016-2017	...
2018-2019	...
2020-2021	...
2022-2023	...
2024-2025	...
2026-2027	...
2028-2029	...
2030-2031	...
2032-2033	...
2034-2035	...
2036-2037	...
2038-2039	...
2040-2041	...
2042-2043	...
2044-2045	...
2046-2047	...
2048-2049	...
2050-2051	...
2052-2053	...
2054-2055	...
2056-2057	...
2058-2059	...
2060-2061	...
2062-2063	...
2064-2065	...
2066-2067	...
2068-2069	...
2070-2071	...
2072-2073	...
2074-2075	...
2076-2077	...
2078-2079	...
2080-2081	...
2082-2083	...
2084-2085	...
2086-2087	...
2088-2089	...
2090-2091	...
2092-2093	...
2094-2095	...
2096-2097	...
2098-2099	...
2100-2101	...
2102-2103	...
2104-2105	...
2106-2107	...
2108-2109	...
2110-2111	...
2112-2113	...
2114-2115	...
2116-2117	...
2118-2119	...
2120-2121	...
2122-2123	...
2124-2125	...
2126-2127	...
2128-2129	...
2130-2131	...
2132-2133	...
2134-2135	...
2136-2137	...
2138-2139	...
2140-2141	...
2142-2143	...
2144-2145	...
2146-2147	...
2148-2149	...
2150-2151	...
2152-2153	...
2154-2155	...
2156-2157	...
2158-2159	...
2160-2161	...
2162-2163	...
2164-2165	...
2166-2167	...
2168-2169	...
2170-2171	...
2172-2173	...
2174-2175	...
2176-2177	...
2178-2179	...
2180-2181	...
2182-2183	...
2184-2185	...
2186-2187	...
2188-2189	...
2190-2191	...
2192-2193	...
2194-2195	...
2196-2197	...
2198-2199	...
2200-2201	...
2202-2203	...
2204-2205	...
2206-2207	...
2208-2209	...
2210-2211	...
2212-2213	...
2214-2215	...
2216-2217	...
2218-2219	...
2220-2221	...
2222-2223	...
2224-2225	...
2226-2227	...
2228-2229	...
2230-2231	...
2232-2233	...
2234-2235	...
2236-2237	...
2238-2239	...
2240-2241	...
2242-2243	...
2244-2245	...
2246-2247	...
2248-2249	...
2250-2251	...
2252-2253	...
2254-2255	...
2256-2257	...
2258-2259	...
2260-2261	...
2262-2263	...
2264-2265	...
2266-2267	...
2268-2269	...
2270-2271	...
2272-2273	...
2274-2275	...
2276-2277	...
2278-2279	...

11	1200	1400	1600	1800	2000	2200	2400	2600	2800	3000	3200	3400	3600	3800	4000	4200	4400	4600	4800	5000	5200	5400	5600	5800	6000	6200	6400	6600	6800	7000	7200	7400	7600	7800	8000	8200	8400	8600	8800	9000	9200	9400	9600	9800	10000				
1	2	3	4	5	6	7	8	9	10	11	12	13	14	15	16	17	18	19	20	21	22	23	24	25	26	27	28	29	30	31	32	33	34	35	36	37	38	39	40	41	42	43	44	45	46	47	48	49	50

Abstract

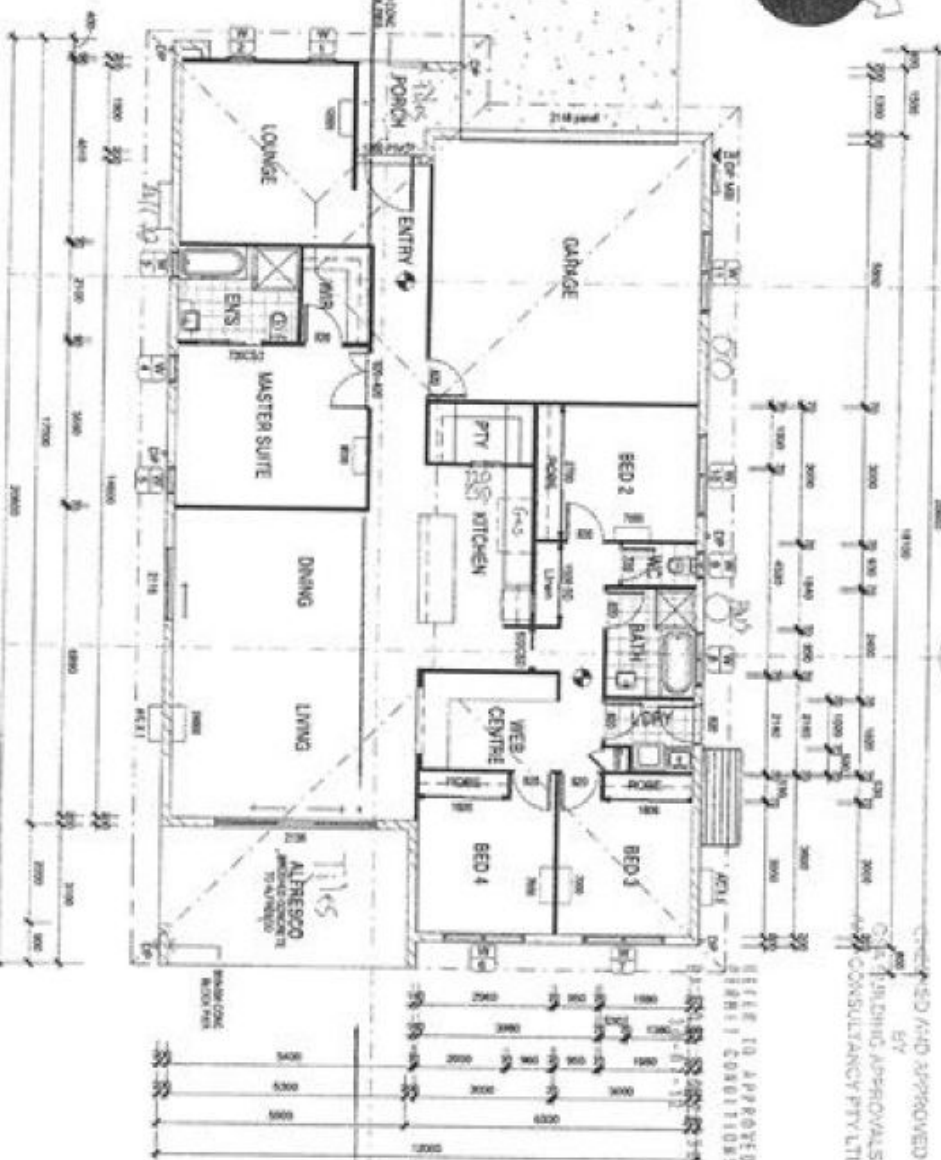
[illegible]

## Ground Floor

① FLOOR - GROUND  
4' 00"

[illegible]