

Harcourts Kingsberry



18 Hillock Crescent BUSHLAND BEACH QLD

4 2 2

This meticulously maintained private family residence full of natural light and set in stunning garden surrounds with a garden shed, high ceilings, excellent indoor/outdoor entertainment living and situated in Bushland Beach. With easy access to Townsville's most elite schools and precinct of Burdell's shops and the Bushland Beach Tavern. Land size 600m2 approx. Comprising: Formal lounge, separate dining, good sized kitchen/meals, informal sitting room opening to entertainment and gardens, 4 bedrooms (master with ensuite bathroom), main bathroom, air conditioning throughout, storage and off street parking for 2 cars.

Located in a fabulous position near shops, cafes, transport, schools and the beach. This property offers many exciting opportunities - move straight in.

18 Hillock Crescent, Bushland Beach

Price : \$ 400,000
Land Size : 600 sqm
View : <https://www.kingsberry.com.au/sale/qld/townsville-district/bushland-beach/residential/home/4326648>



Ben Kingsberry
07 4772 2022
0438 792 652

ben.kingsberry@tsvharcourts.com.au

WIND CATEGORY C2

AREAS

BED 1	14.25 sqm
BED 2	13.17 sqm
BED 3	11.89 sqm
BED 4	11.12 sqm
LOUNGE	14.49 sqm
FAMILY	
DINING	35.32 sqm
KITCHEN	5.86 sqm
BATH	5.86 sqm
WC	1.33 sqm
ENCLAVE	5.74 sqm
LAUNDRY	3.93 sqm
W.I.R.	3.07 sqm
LIVING	55.19 sqm
PATIO	22.82 sqm
GARAGE	38.96 sqm
TOTAL	211.66 sqm

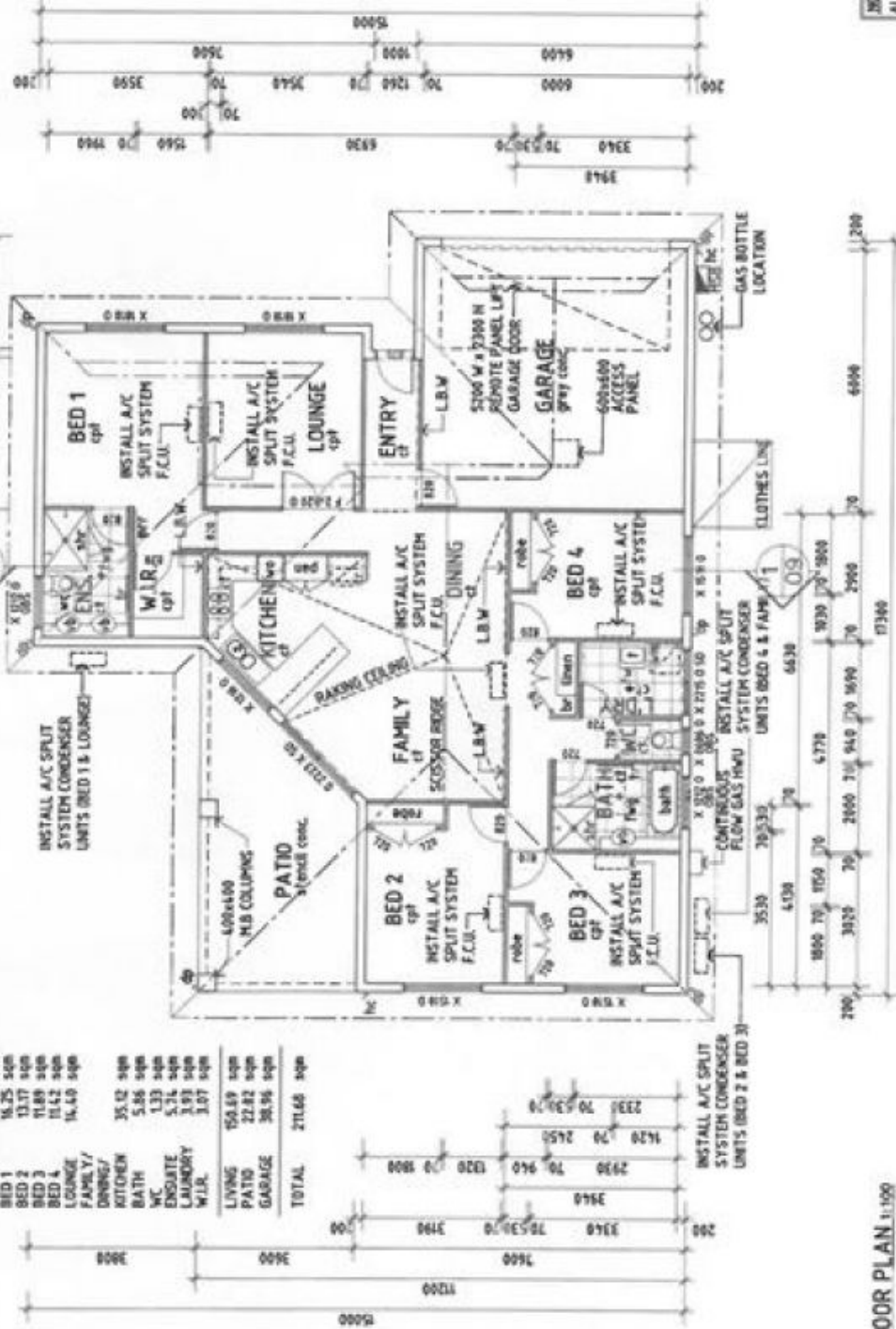

1 FLOOR PLAN 1:100

NOTE
ALL BUILDING MATERIAL TO BE
TERRAZZO TREATED

CHECKED AND APPROVED
BY
GSA BUILDING APPROVALS
AND CONSULTANCY PTY LTD

dan thomson
architectural drafting
© COPYRIGHT
BSA LICENCE NO.
1160376
Address: 167 Denham St,
Townsville, Qld 4810
Phone: 07 47241722
Mobile: 0408 144 482
Fax: 07 47241723
Email: dan@danthomson.com.au

CASE
CONSTRUCTIONS
www.caseconstructions.com.au
Address: PO Box 164
Hyde Park, Qld 4812
Phone: 07 47248700
Fax: 07 47794710

Project: NEW RESIDENCE
Client: [REDACTED]
Location: LOT 7 HILLLOCK CRESCENT,
BUSHLAND BEACH

TITLE: FLOOR PLAN
Date: 26.10.09
Scale: 1:100
Job No: C0071
Drawing No: W004
Designd: [REDACTED]
Rec: [REDACTED]