

Harcourts Kingsberry



7 Tooma Lane KELSO QLD

3 2 2

Located in River Parks Estate this 6 year old home is just minutes to the Ross River Dam, Loam Island Water Sports Facility, plus convenience and grocery stores. Close to schools, parks, transport, sporting facilities and Willows Shopping Centre.

Surrounded by homes of a similar quality this rendered block home has a distinctly modern facade and boasts a large side yard.

Features:

- Three good size bedrooms with built in robes and carpet
- Main bedroom located at the front of the home with ensuite and walk-in robe
- Split-system air-conditioning throughout
- Generous tiled open plan lounge/dining/kitchen which opens onto the entertaining area

Price : \$ 255,000
Building Size : 168 sqm
View : <https://www.kingsberry.com.au/sale/qld/townsville-district/kelso/residential/house/4877383>



Michael Martini
07 4772 2022
0418 731 677
michael.martini@tsvharcourts.com.au

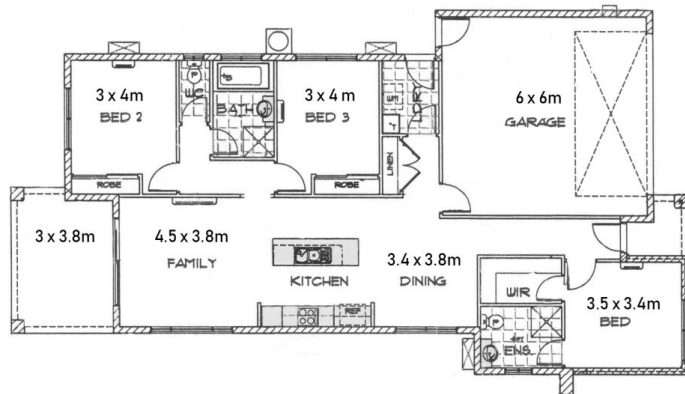

7 Tooma Lane, Kelso