

Harcourts Kingsberry



8 Tartan Place RASMUSSEN QLD

3 1 1

Step inside this beautifully modernised home and be instantly drawn to your private oasis as you walk through the main lounge and living areas. Delivering you to a place where you'll enjoy endless hours entertaining and relaxing. Outside a huge undercover entertaining area overlooks the inviting resort-style in ground pool. Perfectly positioned, the kitchen overlooks the pool and entertaining area, creating a beautiful vista to enjoy while cooking up a storm in your brand-new induction oven.

The modern two-way family bathroom cleverly provides direct access for the main bedroom. Generous in size it also affords a separate bath and large walk-in shower.

The beautifully maintained fully fenced yard includes two sheds, and plenty of room for the kids or pets to roam safely.

This ideal family home is located on a quiet no through road and sits on a large 736m2 block. Positioned close to

Price : \$ 290,000

View : <https://www.kingsberry.com.au/sale/qld/townsville-e-district/rasmussen/residential/house/5632818>



Stephanie Turnbull

07 4772 2022

0459 528 095

stephanie.turnbull@tsvharcourts.com.au

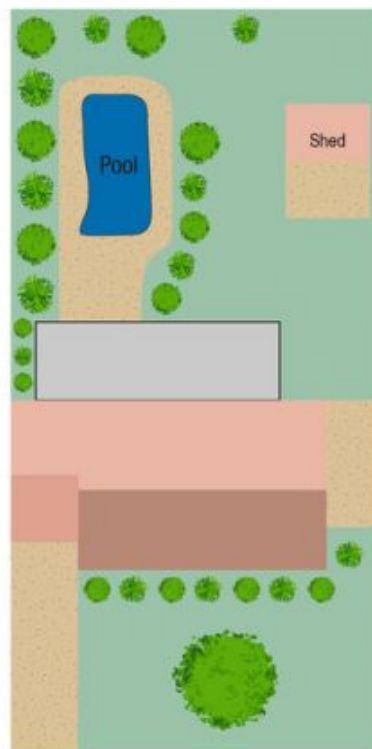
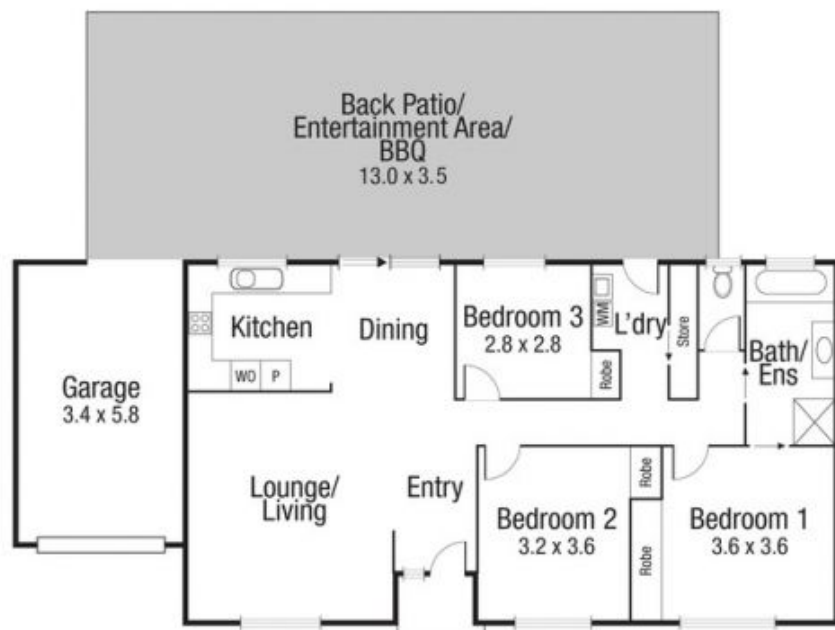

Scale in metres. Indicative only. Dimensions are approximate. All information contained herein is gathered from sources we believe to be reliable. However we cannot guarantee its accuracy and interested persons should rely on their own enquiries.

TOTAL AREA : 187.6 sq.m

8 Tartan Place, Rasmussen