

Harcourts Kingsberry



14 Latchford Street PIMLICO QLD

5 3 2

This very family-friendly, modernized, double storey home on 473sqm is centrally located in Pimlico within minutes of schools, parks, shops, and the Mater Hospital.

Exquisite hardwood timber floors give this home a real warmth, and the freshly painted walls enhance its liveable appeal. There are three bedrooms upstairs including the main with a walk-in wardrobe and ensuite. All of the bedrooms have built-in wardrobes. The main bathroom is classically chic with double vanity and a spacious shower.

Downstairs are two more large bedrooms, another bathroom, a kitchenette, and a large living area. Traditional casement windows and doors ensure excellent breeze flow through the house.

- 5 spacious bedrooms and 3 bathrooms

Price : \$ 400,000
Land Size : 473 sqm
View : <https://www.kingsberry.com.au/sale/qld/townsville-district/pimlico/residential/house/5988089>



Malcolm Thomson
07 4772 2022
0400 545 664
malcolm.thomson@tsvharcourts.com.au

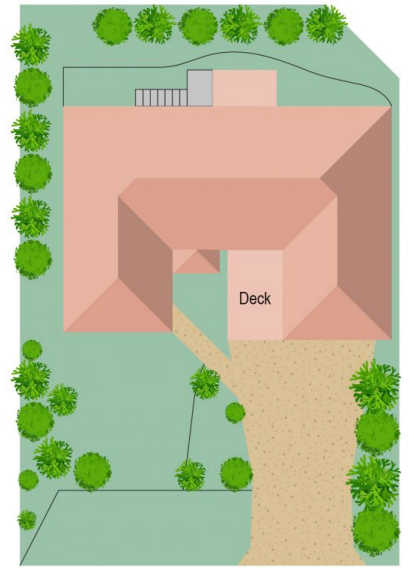
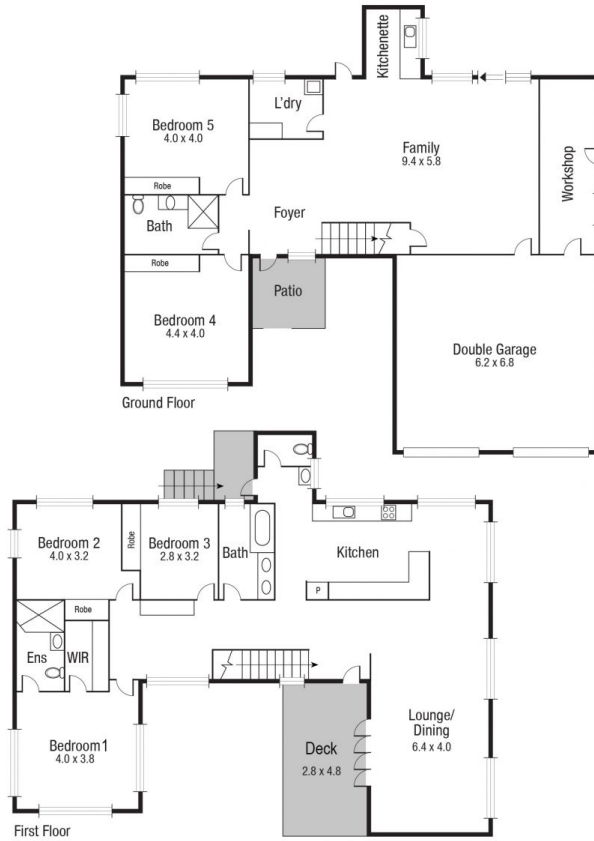

Scale in metres. Indicative only. Dimensions are approximate. All information contained herein is gathered from sources we believe to be reliable. However we cannot guarantee its accuracy and interested persons should rely on their own enquiries.

TOTAL AREA : 305.5 sq.m

14 Latchford St, Pimlico