

# Harcourts Kingsberry



**58 Macarthur Drive ANNANDALE QLD**

4 2 2

This family-friendly, low maintenance, contemporary brick and tile home on 908sqm is ideally located near the Annandale Shopping Centre, schools, parks, and other amenities. On the entertaining and living area side of the house, it has a lovely bush outlook beside a creek that winds its way through the area. The property has been well-maintained and refurbished over the years.

- 4 spacious bedrooms and a large office
- Separate lounge and dining area
- Delightful open plan kitchen with granite benchtops
- Large pantry and plenty of storage
- Rumpus room next to the family area and patio
- Stylish inground pool and entertaining area
- New garden shed and double gate entry to yard
- Pet friendly, fully fenced, landscaped yard
- Refurbished tiled roof, new electric hot water system
- Double lock up garage with remote control door

**Price** : \$ 515,000  
**Land Size** : 908 sqm  
**View** : <https://www.kingsberry.com.au/sale/qld/townsville-district/annandale/residential/house/6000722>



Malcolm Thomson  
07 4772 2022  
0400 545 664  
[malcolm.thomson@tsvharcourts.com.au](mailto:malcolm.thomson@tsvharcourts.com.au)

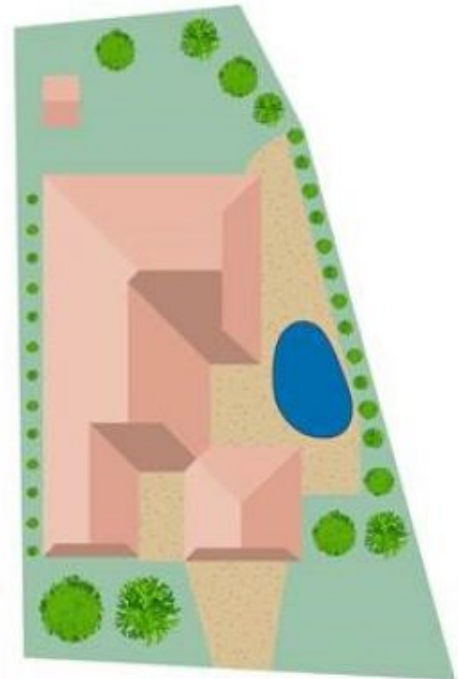
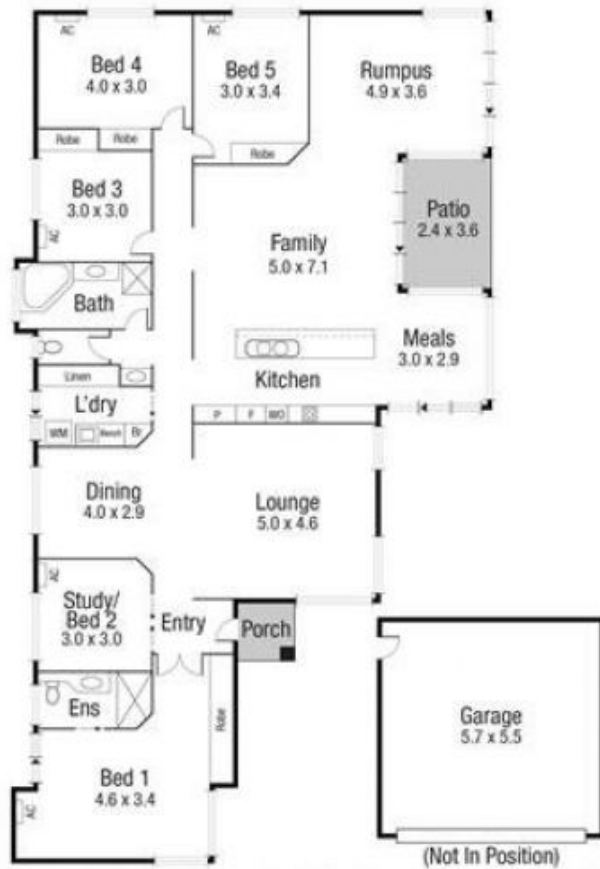

Scale in metres. Indicative only. Dimensions are approximate. All information contained herein is gathered from sources we believe to be reliable. However we cannot guarantee its accuracy and interested persons should rely on their own enquiries.

TOTAL AREA : 233 sq.m

58 Macarthur Drive, Annandale