

Harcourts Kingsberry



17/33 McIlwraith Street SOUTH TOWNVILLE QLD

2 1 1

If location and convenience are important to you, then look no further. At 17/33 McIlwraith Street, the city lifestyle is at your doorstep with just a short stroll to the Palmer Street Restaurant Precinct, Flinders Street, The Strand, Queensland Country Bank Stadium and more. What a refreshing feeling for a Townsville unit; LOW BODY CORPORATE outgoings mean this property will suit both investors who are looking for good capital growth and steady returns plus home buyers looking for an affordable way to escape the rental rat race.

The leaf lined street sets the tone for this complex and despite being just steps away from the city centre, the complex is quiet and feels like a world away from the hustle and bustle. The functional layout of the apartment is impressive, with every area of the home being practically sized and positioned. The neat and tidy kitchen is cleverly

View : <https://www.kingsberry.com.au/sale/qld/townsville-district/south-townsville/residential/unit/6341771>



Ben Kingsberry
07 4772 2022
0438 792 652
ben.kingsberry@tsvharcourts.com.au

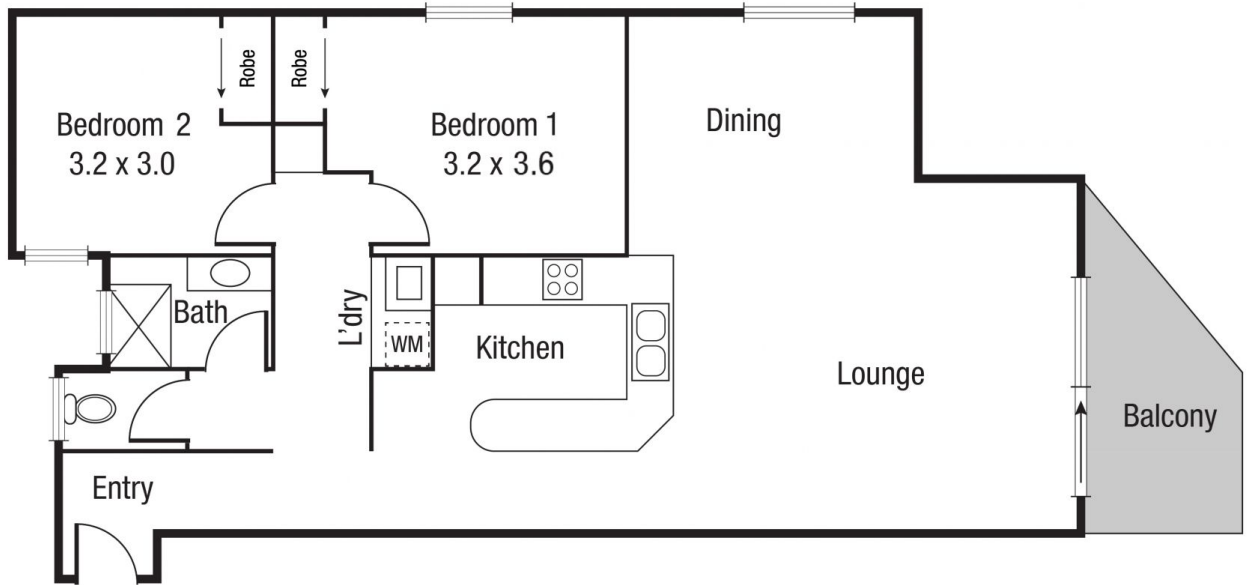

Scale in metres. Indicative only. Dimensions are approximate. All information contained herein is gathered from sources we believe to be reliable. However we cannot guarantee its accuracy and interested persons should rely on their own enquiries.

TOTAL AREA : 85.2 sq.m

17/23 McIlwriath