

Harcourts Kingsberry



28 Summerlake Circuit IDALIA QLD

4  2  2 

Positioned in a quiet pocket in Idalia, this executive family home has recently undergone renovations making it the perfect place to call home.

The stunning cathedral ceilings in the open living/dining space set the standard for the features to come in this quality home. The modern kitchen has certainly been designed with the home chef in mind and comes complete with soft close cabinetry, stone benchtops, ample storage, and quality Westinghouse appliances. The master bedroom is large and features a built-in robe and stylish ensuite.

If space is what you are chasing then look no further, being positioned on a 649sqm block with great double gate side access, this property can grow with your desired needs with more than enough room for a pool or a shed or both, the decision is yours!

Price : \$ 425,000
Land Size : 649 sqm
View : <https://www.kingsberry.com.au/sale/qld/townsville-district/idalia/residential/house/6531491>



Adrian Raiteri
07 4772 2022
0427 673 612
adrian.raiteri@tsvharcourts.com.au

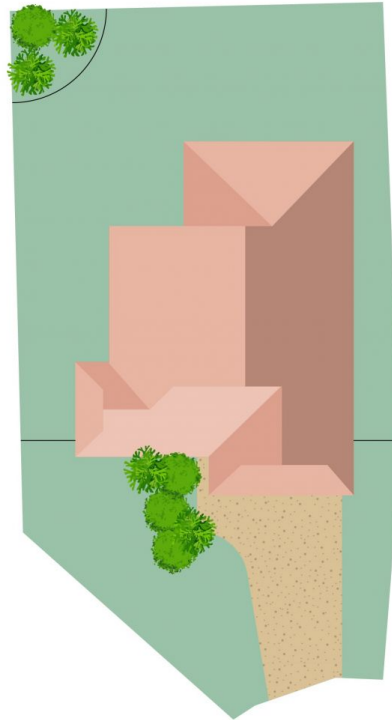
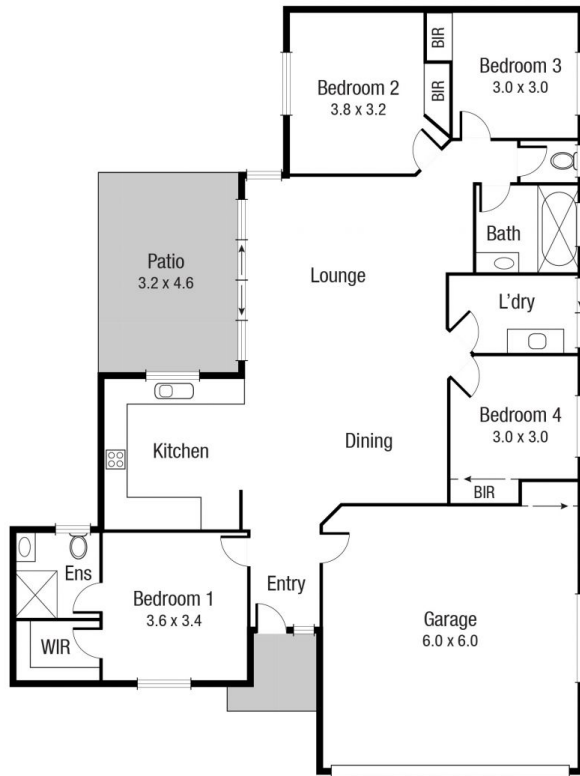

Scale in metres. Indicative only. Dimensions are approximate. All information contained herein is gathered from sources we believe to be reliable. However we cannot guarantee its accuracy and interested persons should rely on their own enquiries.

28 Summerlake Cct, Idalia