

Harcourts Kingsberry



113 Klewarra Boulevard Douglas QLD

4  2  2 

From the moment that you step into this elegant family home you will be blown away by the sheer space and size of this property. Truly an entertainer's delight offering a wide selection of entertaining options, theatre room plus an expansive family room overlooking the private patio, surrounded by well-loved established gardens.

The hub of the home is sure to impress with the state-of-the-art kitchen, highlighting stone bench tops with ample of cupboard space presenting 3 pull out pantries. It even has a separate prep bench with its own sink!!

Warm and welcoming space continues to shine throughout the home, designed and completed to a first - class standard, this immaculate home celebrates contemporary living blended with sophistication and style.

The vast master bedroom is positioned at the rear of the home, complete with a lush ensuite showcasing double shower heads, additional rain shower head, fashionable

Price : \$ 565,000
Land Size : 691 sqm
View : <https://www.kingsberry.com.au/sale/qld/townsville-district/douglas/residential/house/6697943>



Tammy Tyrrell
07 4772 2022
0412 534 704
tammy.tyrrell@tsvharcourts.com.au

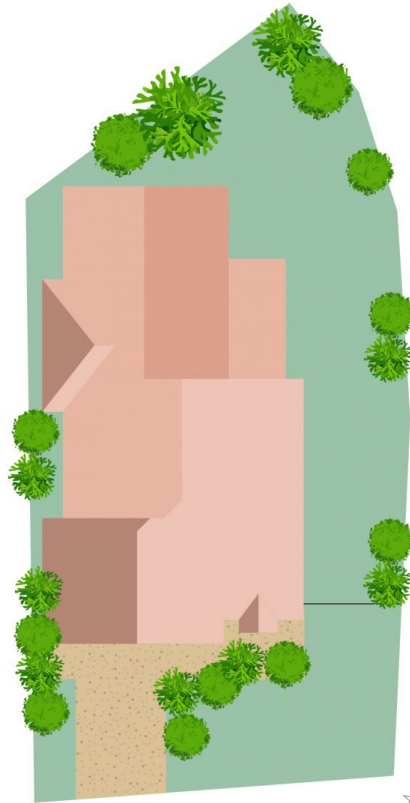

Scale in metres. Indicative only. Dimensions are approximate. All information contained herein is gathered from sources we believe to be reliable. However we cannot guarantee its accuracy and interested persons should rely on their own enquiries.

TOTAL AREA : 240.9 sq.m

113 Klewarra Blvd, Douglas