

# Harcourts Kingsberry



## 1 Carallia Place Douglas QLD

4 2 2

Situated in the Heart of Riverside Gardens. This home boasts 4 bedrooms, 2 bathrooms, 2 separate living areas plus open plan kitchen. A well-appointed kitchen with stainless steel electric cook top, oven, pantry plus breakfast bar.

Spacious living and dining adjoin the kitchen with an addition 2nd living area positioned at the front of the home providing plenty of space for everyone.

The master bedroom presents large built-in robe complete with its own ensuite. The remaining 3 bedrooms feature built in robes and air-conditioning all serviced by the main bathroom highlighting shower/bath combo.

Situated in the popular suburb of leafy Douglas close to James Cook University, Hospital, Lavarack Barracks and a very short drive to Stockland Shopping Centre and Domain Precinct.

**Price** : \$ 485,000  
**Land Size** : 680 sqm  
**View** : <https://www.kingsberry.com.au/sale/qld/townsville-district/douglas/residential/house/7123203>



Tammy Tyrrell  
07 4772 2022  
0412 534 704  
[tammy.tyrrell@tsvharcourts.com.au](mailto:tammy.tyrrell@tsvharcourts.com.au)

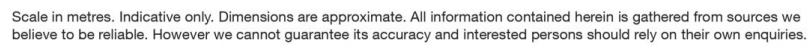
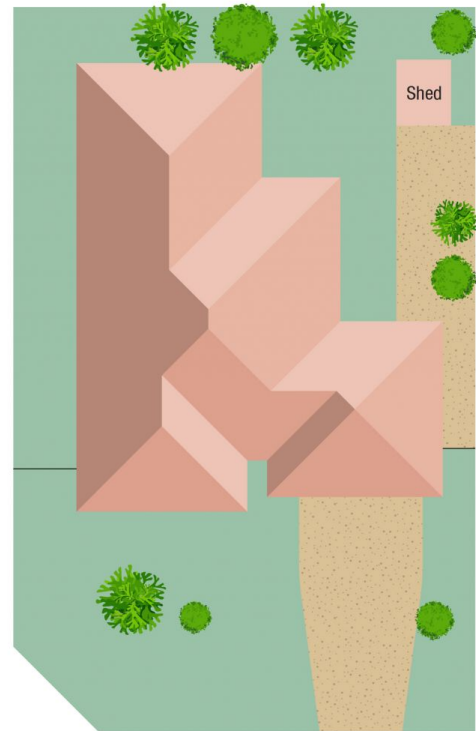

## 1 Carallia Pl, Douglas