

# Harcourts Kingsberry



## 16 Yale Close Douglas QLD

4 2 2

Located a stone's throw from the banks of the Ross River and sitting proudly on a 717sqm corner block at the entrance to one of the most sought-after streets in Riverside Gardens lies this executive family home at 16 Yale Close, Douglas.

**Price** : \$ 535,000  
**Land Size** : 717 sqm  
**View** : <https://www.kingsberry.com.au/sale/qld/townsville-district/douglas/residential/house/7156162>

Entering via the large double doors you are met with a wide hallway and a family living area giving a great sense of space. Making your way through the residence there is a central kitchen overlooking the open living and dining space. The kitchen is well equipped and complete with a large pantry and ample bench and cupboard space with a servery window out to the patio to ensure the home chef is always a part of the conversation. Bedrooms 2,3 & 4 are all complete with built in robes and are positioned away from the master bedroom that features an ensuite and walk in robe. The family bathroom features a shower, tub, and a



Adrian Raiteri  
07 4772 2022  
0427 673 612  
[adrian.raiteri@tsvharcourts.com.au](mailto:adrian.raiteri@tsvharcourts.com.au)

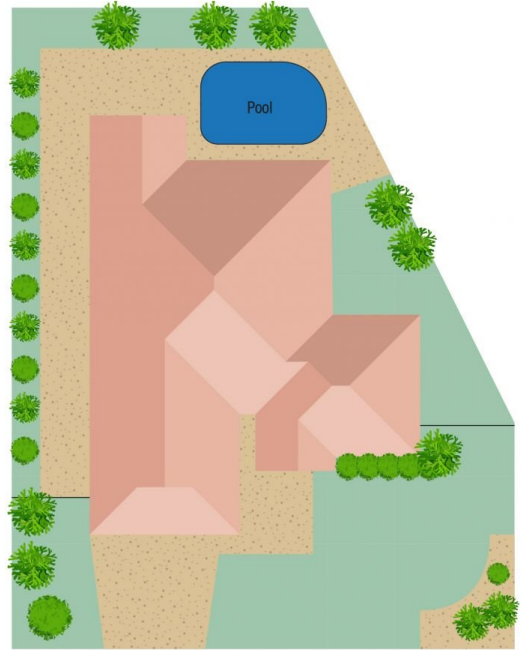
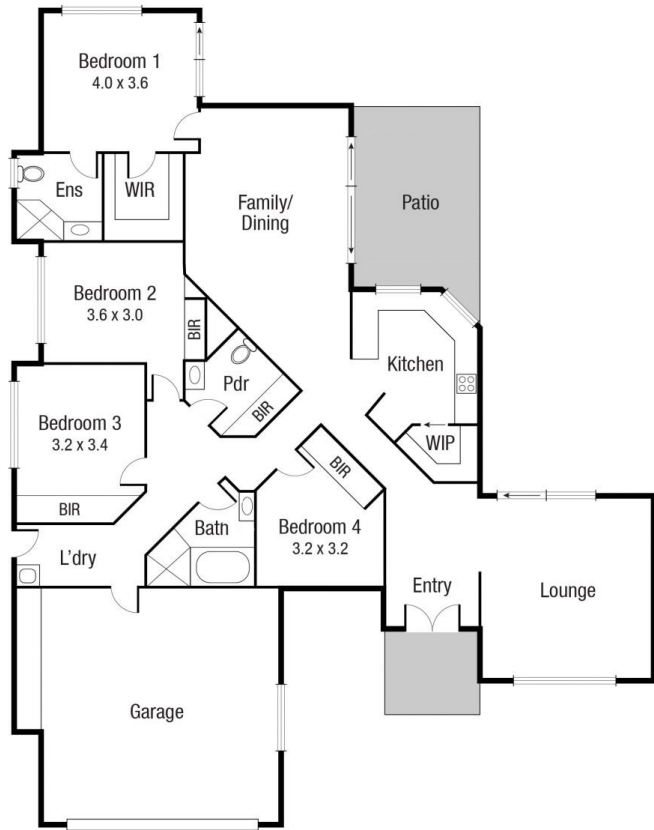

Scale in metres. Indicative only. Dimensions are approximate. All information contained herein is gathered from sources we believe to be reliable. However we cannot guarantee its accuracy and interested persons should rely on their own enquiries.

**TOTAL AREA : 214.3 sq.m**

**16 Yale Cl, Douglas**