

# Harcourts Kingsberry

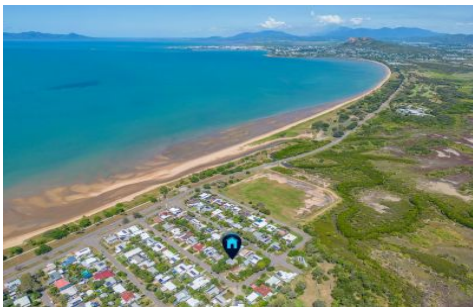

## 18 Seaward Crescent Pallarenda QLD

4 2 2

Your search is finally over but you will need to be quick! First time offered to the market in over 18 years this property has plenty to offer for genuine buyers that appreciate the beauty and relaxed lifestyle that only Pallarenda has.

Surrounded by native trees this property boasts a multitude of colourful butterflies and birds including Birdwings, Ulysses Sunbirds, Honeyeaters, Finches and Rainbow Lorikeets.

Upstairs this spacious family home has 4 built-in bedrooms, 2 are air-conditioned whilst the master has its own private patio. Two bedrooms at each end of the home.

There is a new fully equipped dine-in kitchen with heaps of cupboards, bench space, pantry and large fridge space. Separate airconditioned dining and lounge that opens out

**Land Size** : 607 sqm

**View** : <https://www.kingsberry.com.au/sale/qld/townsville-district/pallarenda/residential/house/7518006>



Mario Torrisi  
07 4772 2022  
0407 636 259

[mario.torrisi@tsvharcourts.com.au](mailto:mario.torrisi@tsvharcourts.com.au)

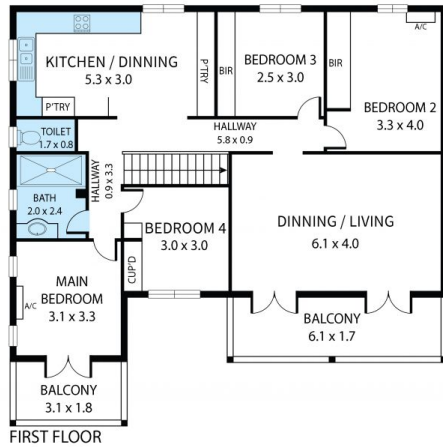

18 Seaward Crescent, Pallarenda 4810  
 TOTAL APPROX. FLOOR AREA 131 SQ.M

Whilst every attempt has been made to ensure the accuracy of the floor plan contained here, measurements of doors, windows, rooms and any other items are approximate and no responsibility is taken for any error, omission, or misstatement. This plan is for illustrative purposes only and should be used as such by any prospective purchaser.

