

Harcourts Kingsberry



28 Goode Lane Oonoonba QLD

3  2  1 

Situated in one of Townsville's most popular fast-growing estate, this is a great opportunity to nest in The Village - known as the ultimate in riverside, parkside and cityside living.

Showcasing unique charm and Parkside vibe this sweet home is ready to move in and enjoy!!

Step inside and you are welcomed by the open plan kitchen, living, and dining area that seamlessly flows to either the front porch overlooking parklands or the rear courtyard for some extra space.

The master bedroom offers views to the park and features and ensuite. The remaining bedrooms are all sizeable with built in robes, split air-conditioning and offer easy access to the main bathroom.

This abode is superbly presented throughout with easy to clean tiles, crisp contemporary tones and abundant natural light creating the perfect canvas for your personal interior

Price : \$ 380,000
Land Size : 250 sqm
View : <https://www.kingsberry.com.au/sale/qld/townsville-district/oonoonba/residential/house/7527889>



Tammy Tyrrell
07 4772 2022
0412 534 704
tammy.tyrrell@tsvharcourts.com.au

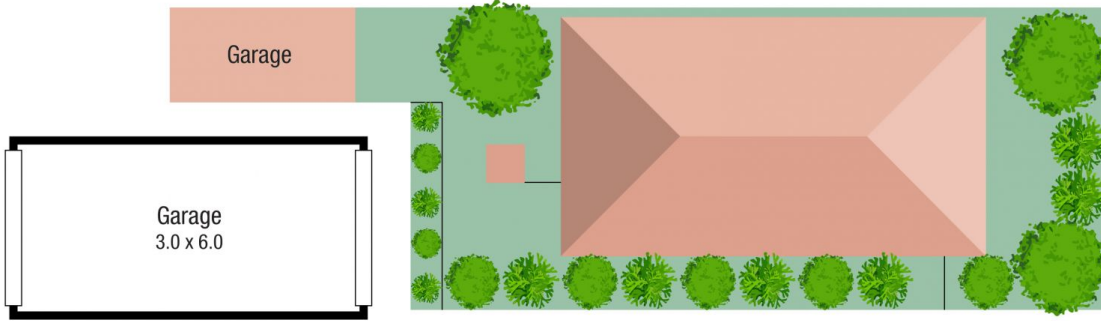

(Not In Position)

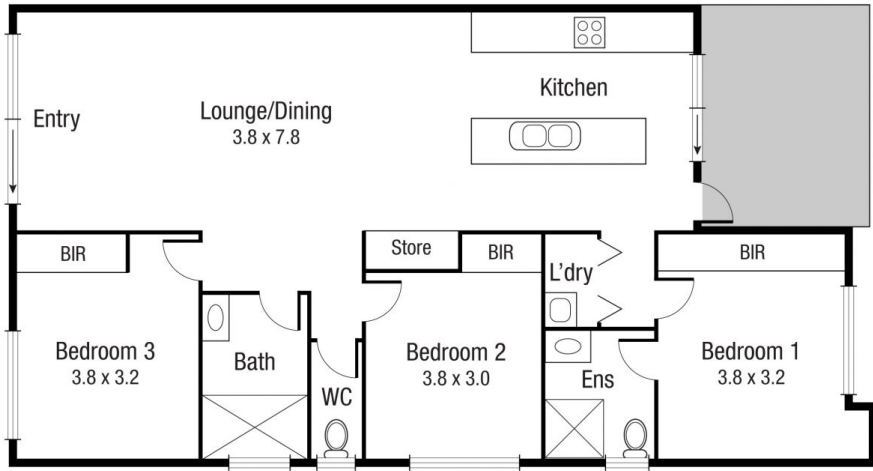

Scale in metres. Indicative only. Dimensions are approximate. All information contained herein is gathered from sources we believe to be reliable. However we cannot guarantee its accuracy and interested persons should rely on their own enquiries.

TOTAL AREA : 113.3 sq.m

28 Goode Lane, Oonoonba