

# Harcourts Kingsberry



## 35 Marblewood Circuit Mount Low QLD

3 1 2

Mount Low is a modern suburb located in the centre of the growth area only 20 minutes north of the Townsville CBD, 5 minutes drive to Bushland Beach Tavern and boat ramp or a 15 minute drive to James Cook University, and Townsville Hospital or Lavarack Barracks via the ring road. Woodlands shopping centre or the North Shore precinct is only 10 minutes away which includes Bunnings, Private and public schools and all your essential services.

**Price** : \$ 426,000  
**Building Size** : 11 sqm  
**Land Size** : 664 sqm  
**View** : <https://www.kingsberry.com.au/sale/qld/townsville-district/mount-low/residential/house/7671509>

### Property Features Include:

- Separate lounge or theatre room
- Open plan living
- 3 good size bedrooms
- Ensuite with walk in robe
- Tiled living areas
- Split system air conditioning



Mike Whitehouse

07 4772 2022

0419 991 355

[mike.whitehouse@tsvharcourts.com.au](mailto:mike.whitehouse@tsvharcourts.com.au)

<https://www.kingsberry.com.au>

210 Charters Towers Road Hermit Park QLD  
07 47 722 022

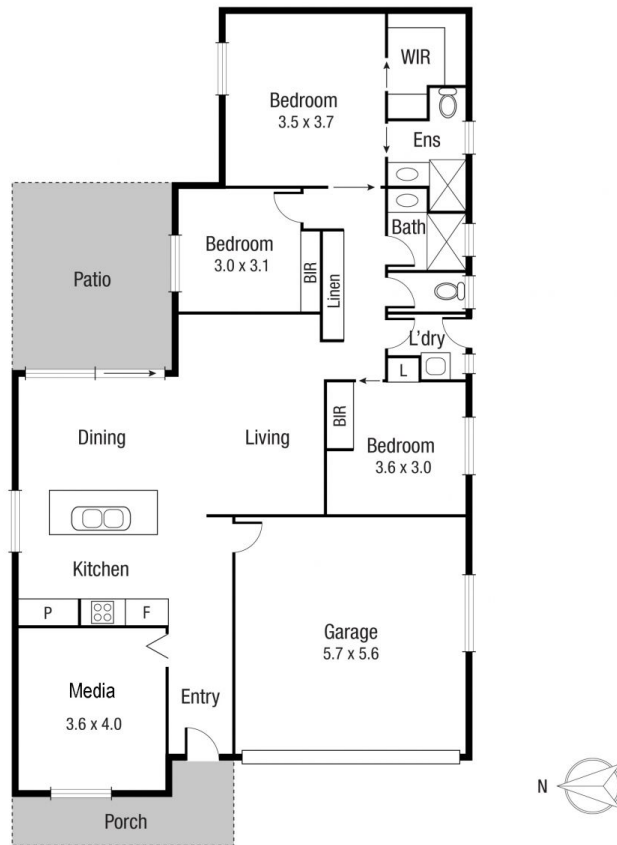

**35 Marblewood Cct, Mount Low**