

Harcourts Kingsberry



15 Shutehaven Circuit Bushland Beach QLD

4 2 2

This well laid out family home has reliable tenants in place who would love to stay on. The current lease is at \$500/week until 3 May 2024 giving a 5.36% return.

This property was sold off market by Cameron Cole in a week to buyers from his extensive Bushland Beach buyer's database.

If you want your Bushland Beach property sold call Cameron now as he has buyers waiting.

Price : \$ 487,500
Land Size : 718 sqm
View : <https://www.kingsberry.com.au/sale/qld/townsville-district/bushland-beach/residential/home/7744334>



Cameron Cole
07 4772 2022
0423 692 422
cameron.cole@tsvharcourts.com.au

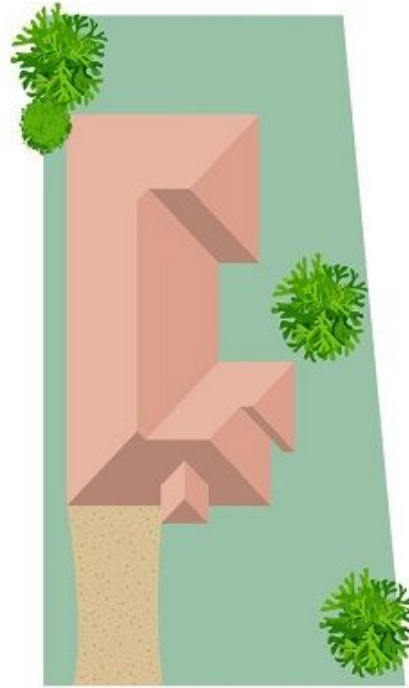

Scale in metres. Indicative only. Dimensions are approximate. All information contained herein is gathered from sources we believe to be reliable. However we cannot guarantee its accuracy and interested persons should rely on their own enquiries.

TOTAL : 247.96 sq.m

15 Shutehaven