

# Harcourts Kingsberry



5/6 Mary Street West End QLD

3 1 1

SOLD BY LORETTA FABBRO.

**Price** : \$ 367,500

**View** : <https://www.kingsberry.com.au/sale/qld/townsville-district/west-end/residential/townhouse/7992553>

Disclaimer: While all care has been taken to ensure the information provided herein is correct, we do not take responsibility for any inaccuracies and we accept no liability for any errors or exclusions (including but not limited to a property's land size, floor plans and building age). Accordingly all interested parties should make their own enquiries and obtain their own legal advice.



Loretta Fabbro

0408 997 766

[loretta.fabbro@tsvharcourts.com.au](mailto:loretta.fabbro@tsvharcourts.com.au)

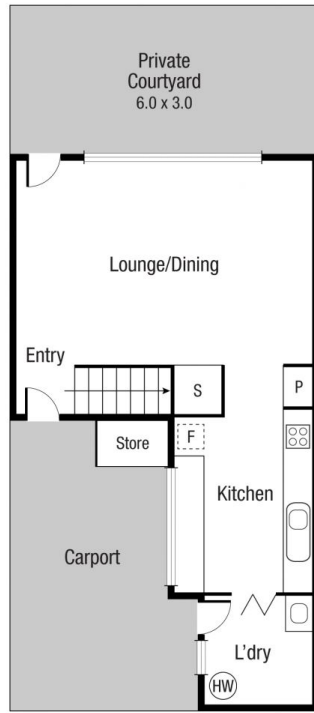

Ground Floor

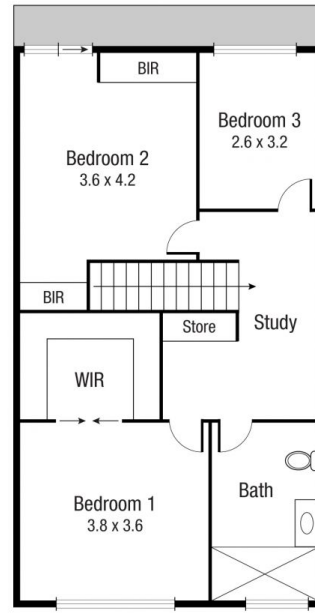

First Floor

Scale in metres. Indicative only. Dimensions are approximate. All information contained herein is gathered from sources we believe to be reliable. However we cannot guarantee its accuracy and interested persons should rely on their own enquiries.

**TOTAL AREA : 156.0 sq.m**

**5/6 Mary St, West End**