

Harcourts Kingsberry



38 Nix Street West End QLD

4  2  2 

Primely positioned in the Ultra-Convenient suburb of West End, only 7 minutes to The Strand, Townsville CBD, Palmer Street Dining Precinct and Queensland Country Bank Stadium, this stunning residence flaunts an impressive array of luxurious high-end finishes and flawlessly showcases magnificence on a grand scale. One step inside spectacular masterpiece and you'll instantly be mesmerised by the simple opulence, and quiet sophistication, this home has to offer. A diamond in the rough, this amazing property is so much more than meets the eye.

Perched atop a generous 809m2 allotment, surrounded by luscious gardens, boasting double gate side access, complete with a 30m concrete driveway to your 10m x 8m Powered, Insulated and Air-conditioned 3 Bay Colourbond Shed, a dedicated BBQ area with two built in OzPig

Price : \$ 660,500
Building Size : 243 sqm
Land Size : 809 sqm
View : <https://www.kingsberry.com.au/sale/qld/townsville-district/west-end/residential/home/8014852>



Kimberley Sorbello
07 4772 2022
0459 351 825
kimberley.sorbello@tsvharcourts.com.au

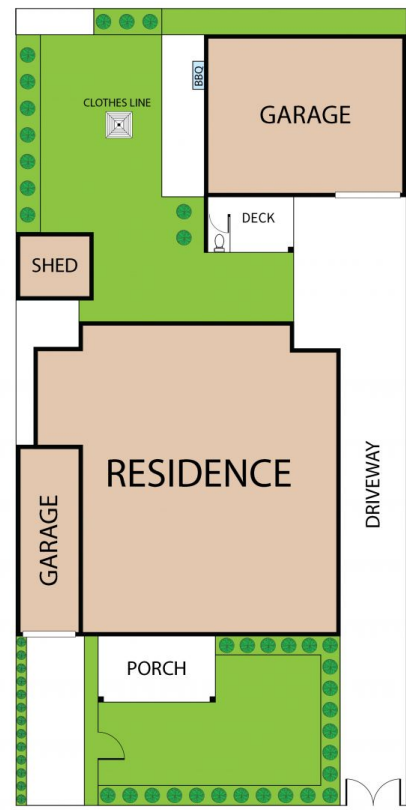

38 Nix Street, West End Queensland 4810

Whilst every attempt has been made to ensure the accuracy of the floor plan contained here, measurements of doors, windows, rooms and any other items are approximate and no responsibility is taken for any error, omission, or misstatement. This plan is for illustrative purposes only and should be used as such by any prospective purchaser.