

# Harcourts Kingsberry



## 8 Ryrie Crescent Rasmussen QLD

3  1  2 

Picture a charming three-bedroom, one-bathroom home nestled in a peaceful suburban neighbourhood. As you approach, the exterior presents a welcoming facade with a two-bay carport and a path leads from the driveway to the front entrance, flanked by lush green lawns and flower beds bursting with colourful blooms.

Upon entering, you find yourself in a cozy foyer that opens up into the heart of the home. To the left, the living room awaits, boasting ample space for relaxation and entertainment. Large windows allow natural light to flood the room, enhancing the warm ambience created by the soft, neutral tones of the walls and plush carpeting underfoot.

Adjacent to the living room is the dining area, a separate space that comfortably accommodates a dining table set

**Price** : \$ 418,500  
**Land Size** : 668 sqm  
**View** : <https://www.kingsberry.com.au/sale/qld/townsville-district/rasmussen/residential/house/8074062>



Jayden Evans  
07 4772 2022  
0477 543 617  
[jayden.evans@tsvharcourts.com.au](mailto:jayden.evans@tsvharcourts.com.au)

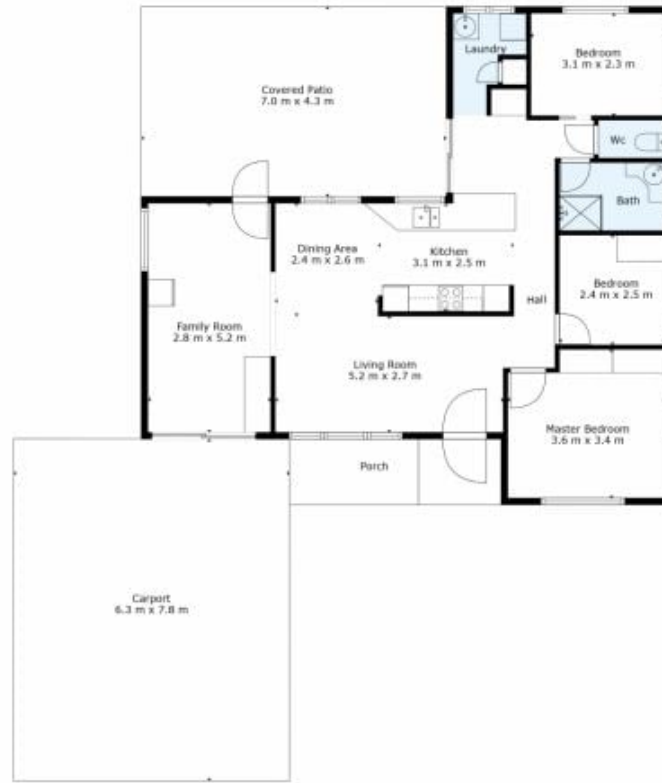

**TOTAL: 89 m<sup>2</sup>**  
 FLOOR 1: 89 m<sup>2</sup>  
 EXCLUDED AREAS: CARPORT: 49 m<sup>2</sup>, PORCH: 4 m<sup>2</sup>, COVERED PATIO: 30 m<sup>2</sup>,  
 "": 3 m<sup>2</sup>

Floor Plan Created By Cubicasa App. Measurements Deemed Highly Reliable But Not Guaranteed.